

# Fosroc® Hydrocell

(Previously known as Stiffjoint)

## Non-absorbent, semi-rigid, polyethylene joint filler

### Uses

Hydrocell is used in forming expansion joints in concrete, brickwork and blockwork and in the construction of water retaining and water excluding structures.

- Brickwork
- Deck slabs
- Basement structures and subways
- Retaining walls
- Raw and potable water reservoirs
- Sewage treatment works
- Irrigation channels and culverts

### Advantages

- Non-absorbent
- Rot proof
- Non-tainting
- Resilient
- Bitumen free
- Heat resistant in applications up to 80°C

### Standards Compliance

Complies with RMS of NSW specification T1204.

### Description

Hydrocell is a semi-rigid, UV resistant, cross-linked, non-absorbent, closed-cell polyethylene sheet material.

Hydrocell is non-tainting and rot proof, therefore, suitable for use in conjunction with suitable joint sealants in structures for the storage of potable water.

### Technical Support

Parchem offers a comprehensive range of high performance, high quality repair, maintenance and construction products. In addition, the company offers a technical support package to specifiers, end-users and contractors, as well as on-site technical assistance.

## Design Criteria

### Example of a sealed expansion joint

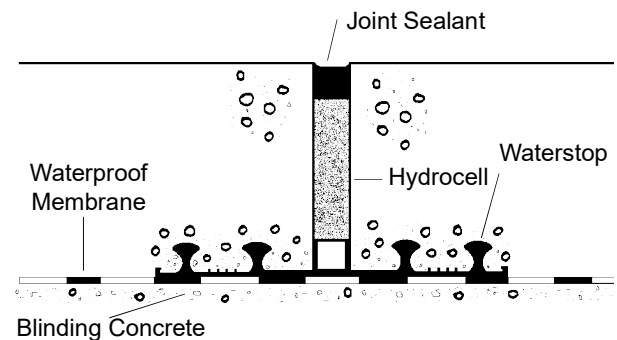

## Properties

<b>Form:</b>	Semi-rigid, closed-cell, polyethylene foam sheet
<b>Density:</b>	110kg ± 5 kg per m <sup>3</sup>
<b>Water absorption:</b>	Less than 2% after 28 days
<b>Compression strength 50% deflection MR610 / T1150:</b>	420 Kpa
<b>Recovery T1150:</b>	>90%
<b>Extrusion MR610 / T1150:</b>	0.5 mm
<b>Accelerated Weathering Test MR610 / T1150:</b>	Excellent / no degradation
<b>Resistance to bacteriological attack:</b>	Excellent
<b>Resistance to chemicals -</b>	Immersion for 7 Days
<b>Hydrochloric acid 10%:</b>	No reaction
<b>Caustic soda 10%:</b>	No reaction
<b>Acetone:</b>	No reaction
<b>Premium motor fuel:</b>	No reaction, slight swelling
<b>Diesel fuel:</b>	No reaction, slight swelling

# Fosroc® Hydrocell

## Application Instructions

### Joint sealing slots

When forming expansion joints with Hydrocell in in-situ concrete, Hydrocell can be supplied pre-cut with a “zip top” to site requirements or joint sealing slots can be readily formed in the following manner. Before installing, simply cut off a strip to the required depth then pin the strip back onto the main filler using small nails. Then install the filler flush with the finished surface.

Prior to sealing, the top strip can then be pulled easily from the joint to provide an uncontaminated sealing slot ready for preparation and sealing. As elastomeric sealants will not bond to Hydrocell the additional need for bond breaker strips is eliminated.

### Suspended Slabs

When installing Hydrocell in expansion joints between suspended slabs, partly projecting copper nails or daubs of adhesive may be used to help prevent displacement.

## Estimating

Hydrocell is supplied in the following sheet sizes and can be easily cut to the required size with a sharp knife or fine saw:

<b>Sheet size:</b>	2.0 m long x 1 m wide	
<b>Sheet thickness:</b>	10mm:	FC701101-UNIT
	15mm	FC701106-UNIT
	20mm	FC701107-UNIT

<b>Cut strips:</b>		
2.0m x 50mm x 10mm		FC701109-UNIT
2.0m x 75mm x 10mm		FC701110-UNIT
2.0m x 100mm x 10mm		FC701104-UNIT
2.0m x 150mm x 10mm		FC701105-UNIT
2.0m x 200mm x 10mm		FC701108-UNIT

<b>Sheet size:</b>	2.4 m long x 1.2 m wide	
<b>Sheet thickness:</b>	10mm:	FC701000-UNIT
	15mm	FC701010-UNIT
	20mm	FC701015-UNIT
	(7, 12 & 25mm thickness x 1.0m wide Made to Order)	

<b>Cut strips:</b>		
1.5m x 100mm x 10mm		FC720975-UNIT
1.5m x 125mm x 10mm		FC700870-UNIT
2.4m x 50mm x 10mm		FC701045-UNIT
2.4m x 75mm x 10mm		FC701050-UNIT
2.4m x 100mm x 10mm		FC720980-UNIT
2.4m x 125mm x 10mm		FC700990-UNIT
2.4m x 150mm x 10mm		FC700995-UNIT
2.4m x 200mm x 10mm		FC701030-UNIT
1.4 x 100mm x 10mm	MTO	FC700850-UNIT
1.5m x 75mm x 10mm	MTO	FC700920-UNIT
2.4m x 250mm x 10mm	MTO	FC701035-UNIT
2.4m x 300mm x 10mm	MTO	FC701040-UNIT

## Storage

Hydrocell should be stored in a clean area and not left exposed for long periods, especially in hot climates.

### Important notice

A Safety Data Sheet (SDS) and Technical Data Sheet (TDS) are available from the Parchem website or upon request from the nearest Parchem sales office. Read the SDS and TDS carefully prior to use as application or performance data may change from time to time. In emergency, contact any Poisons Information Centre (phone 13 11 26 within Australia) or a doctor for advice.

### Product disclaimer

This Technical Data Sheet (TDS) summarises our best knowledge of the product, including how to use and apply the product based on the information available at the time. You should read this TDS carefully and consider the information in the context of how the product will be used, including in conjunction with any other product and the type of surfaces to, and the manner in which, the product will be applied. Our responsibility for products sold is subject to our standard terms and conditions of sale. Parchem does not accept any liability either directly or indirectly for any losses suffered in connection with the use or application of the product whether or not in accordance with any advice, specification, recommendation or information given by it.



constructive solutions

Sold under license from Fosroc International Limited.  
Fosroc and the Fosroc logo are trade marks of Fosroc International Limited, used under license. .

**Parchem Construction Supplies Pty Ltd**  
7 Lucca Road, Wyong NSW 2259  
Phone: 1300 737 787  
www.parchem.com.au  
ABN 80 069 961 968

Distributed in New Zealand by: Concrete Plus Ltd  
23 Watts Rd, Sockburn 8042 Ph: 0800 657 156